



# Doorbell Wired

## Wi-Fi Video Doorbell

Doorbell Wired supports up to 1080P Full HD video with super wide field of view, which enable you to see your house through the cellphone clearly who is visting. And you can talk with him remotely from your cellphone even when you are not at home.



**HD Video**  
2MP CMOS, 1080P



**Super Wide View Angle**  
Horizontal 140°



**PIR Detection**  
Horizontal 120° , 5m(16.5ft)



**Night Vision**  
5m(16.5feet) IR distance



**Two-way Talk**  
Real-time video and audio talk



**Power**  
AC16~24V, DC12/24V



**Cloud Service**  
Cloud talk, cloud storage



**Wi-Fi Connection**  
IEEE802.11b/g/n(2.4GHz)

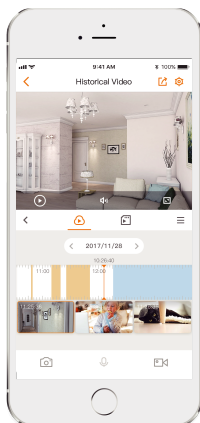

## Stay close with what you care

With Cloud service, you will have access to what you care as long as Internet is available . You can record motion videos on Cloud and play back anytime anywhere.



Front View

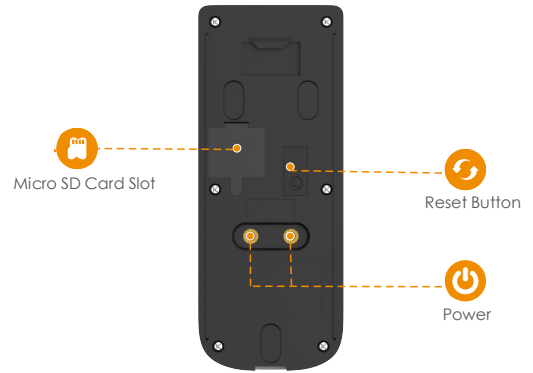

Back View

## Specifications

### Camera

1/2.7" 2 Megapixel progressive CMOS  
 2MP(1920 x 1080)  
 Night Vision: 5m(16.5ft) distance  
 1.9mm fixed lens  
 Field of View : 140° (H), 158° (D)

### Video & Audio

Video Compression : H.264  
 Audio Compression : G.711  
 Up to 20fps Frame Rate  
 Two-way Bidirectional Talk  
 Echo cancellation

### Notice Management

Call Notification  
 PIR Detection  
 Configurable PIR area

### Network

Wi-Fi:IEEE802.11b/g/n,2.4GHz  
 imou app: iOS, Android

### Auxiliary Interface

Micro SD Slot (up to 64GB)  
 Built-in Mic & Speaker  
 Reset button  
 Micro USB power port

### General

AC16~24V, DC12/24V Power supply  
 Power Consumption: <9W  
 Surface mounted  
 Working Environment:-20° C~+50° C, Less than 95%RH  
 Dimensions: 119 × 47 × 29.3mm(4.7 × 1.9 × 1.2inch)  
 Weight: 200g (0.44lb)  
 CE, FCC

## What's in the box

- 1x Doorbell Wired
- 1x Quick Start Guide
- 1x Surface mounted holder
- 1x Cable Package
- 1x ChimeKit
- 1x Screw Package
- 1x Horizon level
- 1x Screwdriver bit
- 1x Screwdriver handle

